

# EZ TUBE BARRIER OUTDOOR LARGE

PRODUCT CATEGORY: EZ FABRIC DISPLAYS

PRODUCT CODE: EZBRRLGOD

## SET UP INSTRUCTIONS

### Set Up Frame

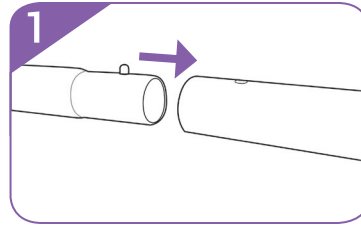
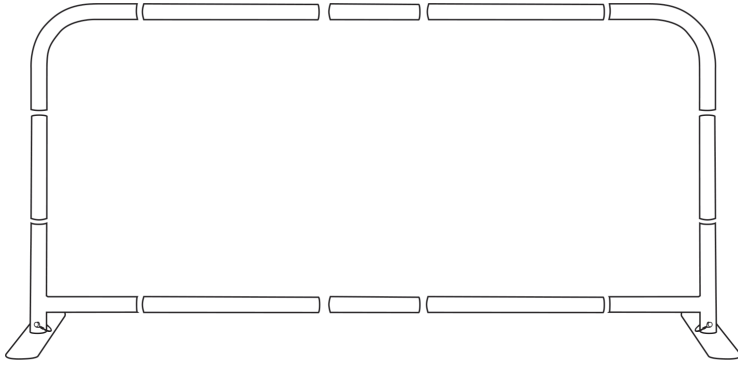

1 Connect numbered tubes together.

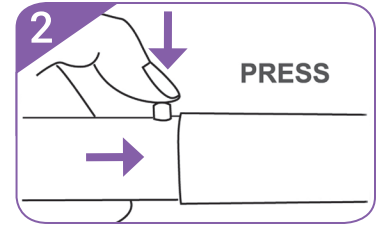

2 Push down on button and insert tube.

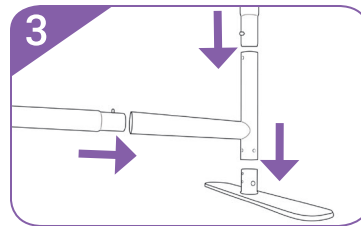

3 Attach corner tube onto feet. Then connect vertical and horizontal tubes to complete frame.

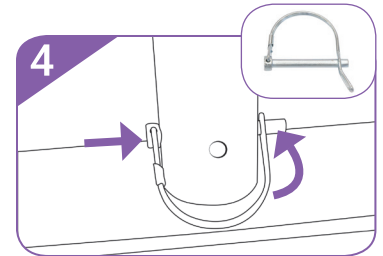

4 Insert wire lock pin onto the side of feet. Then pull wire loop over end of the pin to secure feet.

### Install Graphic

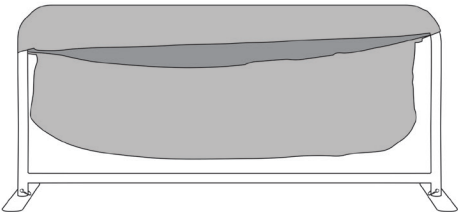

a. Drape graphic over frame.

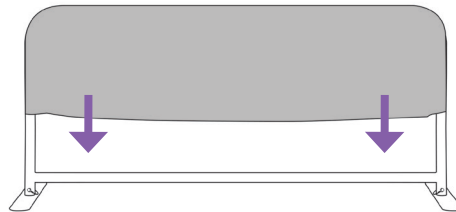

b. Pull down graphic to cover whole frame.



c. Zip underneath the bottom support pole.

### Optional Connection



a. Use barrier connector foot to arrange your own combination barrier.



b. Place frames onto barrier connector foot and lock with wire lock pins.



c. Arrange barrier either straight or corner.

